

FAITHFULL®

QUALITY TOOLS

FAI DOWJIG2

Dowelling Jig

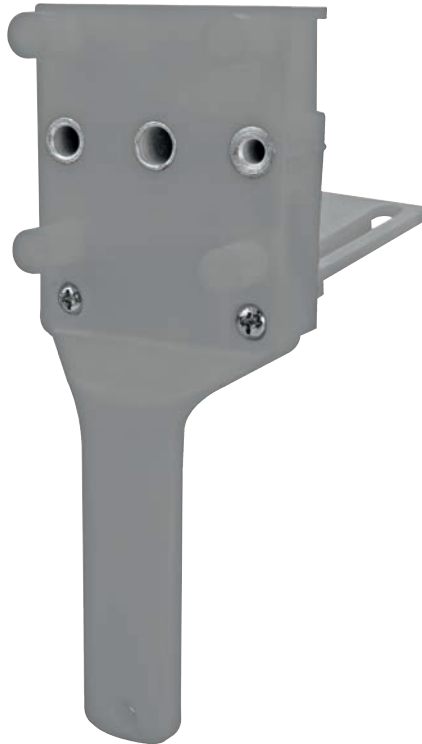

Instruction Manual

Before using this product, read this manual entirely and follow all safety rules and operating instructions.

Keep this manual for future reference.

5 Year Warranty

This Faithfull Quick Dowel Jig is warranted against defects in material and workmanship for five years from the date of purchase. The obligation of the manufacturer under this warranty is limited to replacement or repair of the product or of any defective portions thereof.

This warranty extends to the first purchaser only and does not apply to conditions resulting from abuse, misuse, alteration, negligence, improper maintenance, or normal wear and tear. Unauthorized repairs or tampering with the product will void this warranty in its entirety.

Warranty claims should be accompanied by a valid proof of purchase. Faithfull shall not be liable for loss or damage of any kind including incidental or consequential damages, resulting either directly or indirectly from the use of this product.

If you find a defect in material or workmanship, contact the Faithfull Customer Service department.

Faithfull Tools,
Phoenix House,
3 White Lodge Business Estate,
Hall Road,
Norwich,
Norfolk,
NR4 6DG,
United Kingdom

e-mail: enquiries@faithfulltools.com

Telephone: 01322 321 415

www.faithfulltools.com

Available Accessories

Fluted wood dowel pegs:

FAI DOW672P	30 x 6mm	Pack of 72
FAI DOW6300T	30 x 6mm	Tub of 300
FAI DOW850P	40 x 8mm	Pack of 50
FAI DOW8150T	40 x 8mm	Tub of 150
FAI DOW1035P	40 x 10mm	Pack of 35
FAI DOW10100T	40 x 10mm	Tub of 100

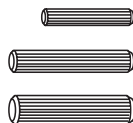

Suitable wood drills:

FAI WDB60	6mm Wood Drill Bit
FAI WDB80	8mm Wood Drill Bit
FAI WDB100	10mm Wood Drill Bit

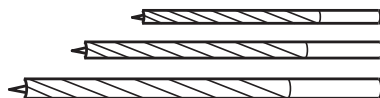

Dowel Drill Stops:

FAI DOWDSTOPS	6, 8 & 10mm Drill Stops
---------------	-------------------------



Read all safety instructions before using

Read the owner's manual carefully. Learn applications of the product and its limitations as well as any specific or potential hazards.

Protect yourself against personal injury

Safety equipment may reduce your potential for injury, but even this will not make up for poor judgment, carelessness or inattention.

Treat all tools with respect and exercise caution, as this will considerably reduce the possibility of personal injury.

ALWAYS

exercise caution in the workshop. Please note that if normal safety precautions are overlooked or ignored personal injury to the operator may result.

DO NOT operate any tool while under the influence of drugs, alcohol, or any medication.

Dress for safety

DO NOT wear loose clothing, gloves, neckties, or jewellery, as these items can get caught and draw you into moving parts.

ALWAYS wear non-slip footwear.

Tie back long hair. Roll long sleeves above the elbow.

ALWAYS maintain a good firm foothold. Keep well balanced.

Keep work area clean

ALWAYS keep your work area clean, uncluttered, and well lit.

Always use eye protection

Eye protection should always be worn when using tools, goggles to EN166:1B or safety glasses to EN166:1F should be always be worn. Everyday glasses only have impact resistant lenses and do not offer suitable protection when using tools.

Do not force the tool

Do not force a tool or apply undue pressure or attempt to carry out any operation that it was not designed to do. Always use the right tool for the job and only for the purpose for which it was designed. Do not attempt to adapt or modify a tool for an alternative purpose, or to gain a greater working capacity than that for which it was intended.

Use clamps or a vice to hold work when practical

Using clamps or a vice to hold a workpiece is safer than using your hand. It also frees both hands to operate the tool.

Keep tool clean

After use, clean sawdust off the Quick Dowel Jig and drill.

Warning: If you are using a powered drill always disconnect the power cord when installing the drill bit and/or adjusting the depth stops. Cordless drills should have their trigger lock engaged.

Use recommended accessories

Consult this manual for recommended accessories. Follow the instructions that accompany the accessories. The use of improper accessories may cause hazards.

Ensure safety of others

Keep visitors and children a safe distance away from the work area, especially when operating a power tool. Visitors should wear the same safety equipment as the operator.

Remember: your personal safety is your responsibility.

This tool was designed for dowelling applications only. We strongly recommend that it is neither modified nor used for any applications other than those for which it was designed

Retain these instructions for future reference

Unpacking and checking contents

Your Faithfull Quick Dowel Jig is shipped complete in one box. Make sure all items are accounted for before discarding any of the packaging materials.

Separate all parts from packaging materials and check each item against the package contents below.

KEY NO.	DESCRIPTION	QTY
1	Dowel Quick jig	1
2	Angle piece	1
3	Clamping screw	2
4	Square nut	2

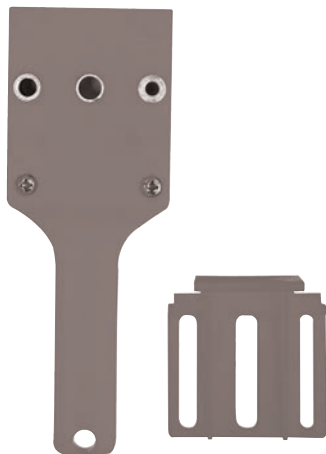

Introduction

The Faithfull Quick Dowel Jig is designed for creating professional joints in many types of wood and man-made boards. It can be used for a variety of purposes, including corners, mitres, and 'T' joints, and works with all popular hand and power drills.

This tool includes the dowelling jig and angle piece.

We are certain you will find the Faithfull Quick Dowel Jig a valuable addition to your workshop.

Selecting the correct sized dowel

The following chart will help you select the proper size dowel to use for your application:

Board Thickness	Dowel Size
12 - 14mm	6mm
15 - 17mm	8mm
17 - 23mm	10mm

Helpful Hints

1. For extra narrow boards it may be necessary to shorten the dowel or to drill out a deeper hole in the edge of the matching board.
2. Be sure to mark the boards as described in the instructions.
3. Make some practice joints on scrap material before using your Quick Dowel Jig for the first time on good wood.
4. Always use a depth stop to assure an even depth of all the holes and to be sure you do not drill the holes too deep.
5. Use only 6mm, 8mm, or 10mm drill bits to avoid damage to the bushings. Regularly withdraw the drill as necessary to clear wood shavings from the hole and bit.
6. Do not glue until you have finished all of the jointing operations and you are certain that all the work pieces fit together exactly.

Making Corner Joints

1. Align two boards in their finished position and mark them "A" and "B". See Figure 1.
2. Clamp board A to a workbench or clamping table. See Figure 2.
3. Using the Quick Dowel Jig as a guide, place a depth stop on the drill bit at the proper depth for your first hole.
4. Place your Quick Dowel Jig, with the 4 centring pegs pointed down, flat against the edge of board A. Choose the size hole you want to drill and twist the jig to centre it on the end of the board and contact the opposite side with the centring pegs. Depending on the desired hole size, different pairs of pegs are used to centre the jig on the board. See Figures 3-6.

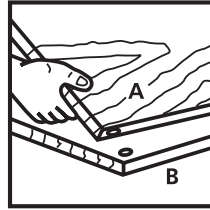

Figure 1

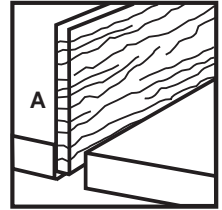

Figure 2

5. Drill through the Quick Dowel Jig and into the edge of the board. Repeat the twist and drill sequence in step 4 as you move down the edge of the board until all holes have been drilled.
6. After all holes have been drilled, place dowel pins in each hole WITHOUT GLUE. These will be used to position the guide for drilling holes in board B.

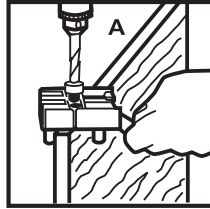

Figure 3

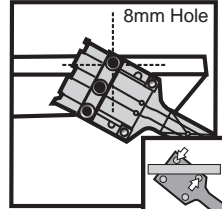

Figure 4

7. Attach the angle piece to the dowel jig using the screws and square nuts. Insert the screws through the two holes on the top of the jig and attach the square nuts to the bottom. Do not tighten. Slide the angle piece into the slot between the bottom of the jig and the square nut. Keep the angle piece slightly loose. See Figure 7.

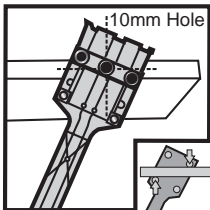

Figure 5

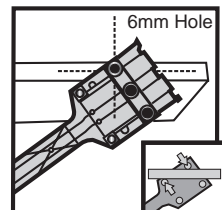

Figure 6

8. Place the jig and angle piece assembly over any one of the dowels in the edge of board A. Slide in the angle piece against the board and tighten the screws. Ensure the slot in the angle piece is aligned with the hole you have made. See Figure 8.

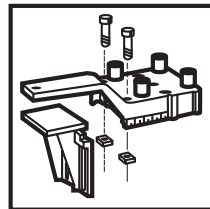

Figure 7

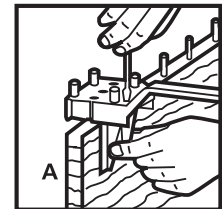

Figure 8

9. Remove board A from the clamps and lay it flat on the workbench with the dowel pins facing out. Place board B on top of board A with the side you want to drill facing up. Line up the end of the boards using a square. Board B should slightly overlap the joint edge of board A to ensure the jig lies against the edge of board B rather than the edge of board A. Clamp both boards on both sides of the workbench. See Figure 9.

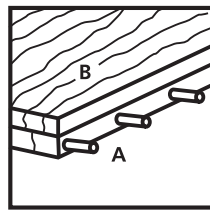

Figure 9

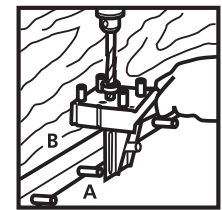

Figure 10

11. Apply wood glue to the dowel pins and assemble the joint.

Making T-butt joints 25mm or less from edge

1. Align two boards in the finish position and mark them "A" and "B". Mark a line on board B for the centre points of the dowels. See Figure 11.
2. Clamp board A to a workbench or clamping table. See Figure 12.
3. Using the Quick Dowel Jig as a guide, place a depth stop on the drill bit at the proper depth for your first hole.
4. Place your Quick Dowel Jig, with the 4 centring pegs pointed down, flat against the edge of board A. Choose the size hole you want to drill and twist the jig to centre it on the end of the board and contact the opposite side with the centring pegs. Depending on the desired hole size, different pairs of pegs are used to centre the jig on the board. See Figures 13-16.
5. Drill through the Quick Dowel Jig and into the edge of the board. Repeat the twist and drill sequence in step 4 as you move down the edge of the board until all holes have been drilled.
6. After all holes have been drilled, place dowel pins in each hole WITHOUT GLUE. These will be used to position the guide for drilling holes in board B.
7. Attach the angle piece to the dowel jig using the screws and square nuts. Insert the screws through the two holes on the top of the jig and attach the square nuts to the bottom. Do not tighten. Slide the angle piece into the slot between the bottom of the jig and the square nut. Keep the angle piece slightly loose. See Figure 17.
8. Remove board A from the clamps and lay it flat on the workbench with the dowel pins facing out. Place board B on top of board A with the side you want to drill facing up. Line up the end of the boards using a square. Clamp both boards on both sides of the workbench. See Figure 18.
9. Place the Quick Dowel Jig on top of board B with the pegs of the jig pointing up. Line up the markers on the sides of the Quick Dowel Jig with the centre line you marked earlier for the dowels in board B. Slide in the angle piece over one of the dowel pins in board A, using the appropriate slot in the angle piece. With the angle piece flush against the edge of board B, tighten the screws. See Figure 19.
10. Using the Quick Dowel Jig as a guide, set the depth stop on the drill bit so you do not drill through board B. Drill a hole for each dowel pin. See Figure 20.
11. Apply wood glue to the dowel pins and assemble the joint.

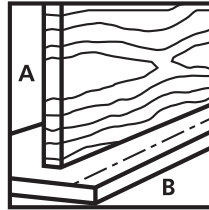

Figure 11

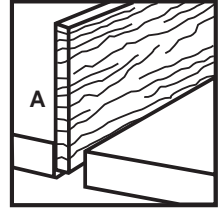

Figure 12

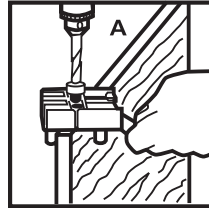

Figure 13

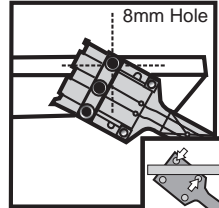

Figure 14

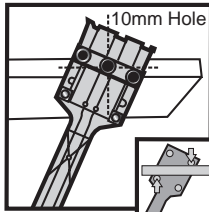

Figure 15

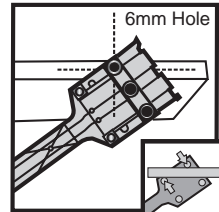

Figure 16

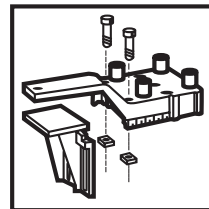

Figure 17

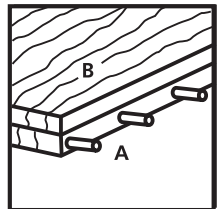

Figure 18

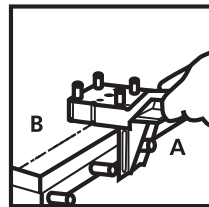

Figure 19

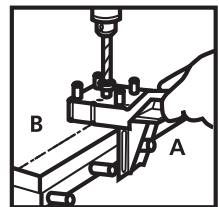

Figure 20

Making T-butt joints more than 25mm from edge

1. Align two boards in the finish position and mark them "A" and "B". Mark a line on board B for the centre points of the dowels. See Figure 21.

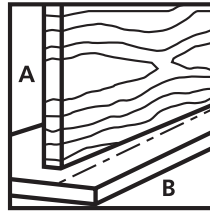

Figure 21

2. Clamp board A to a workbench or clamping table. See Figure 22.

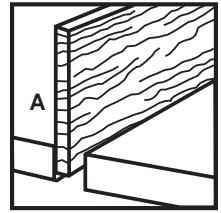

Figure 22

3. Using the Quick Dowel Jig as a guide, place a depth stop on the drill bit at the proper depth for your first hole.

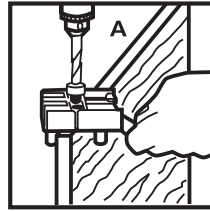

Figure 23

4. Place your Quick Dowel Jig, with the 4 centring pegs pointed down, flat against the edge of board A. Choose the size hole you want to drill and twist the jig to centre it on the end of the board and contact the opposite side with the centring pegs. Depending on the desired hole size, different pairs of pegs are used to centre the jig on the board. See Figures 23-26.

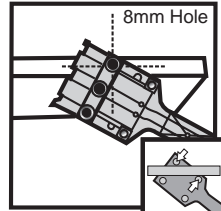

Figure 24

5. Drill through the Quick Dowel Jig and into the edge of the board. Repeat the twist and drill sequence in step 4 as you move down the edge of the board until all holes have been drilled.

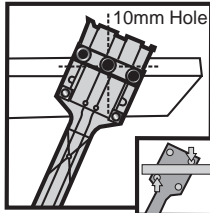

Figure 25

6. After all holes have been drilled, place dowel pins in each hole WITHOUT GLUE. These will be used to position the guide for drilling holes in board B.

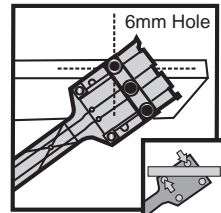

Figure 26

7. Place board B flat on workbench. Place board A on board B with the edge of board A approximately 35mm away from the centre line marked on board B. See Figure 27.

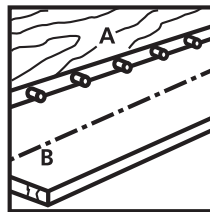

Figure 27

8. Turn the Quick Dowel Jig over so the pegs face up and slide the slot on the front of the jig over the corresponding dowel pins. See Figure 28.

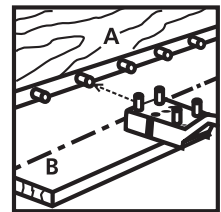

Figure 28

9. Match the centre marks on both sides of the jig with the centre line on board B. Line up the end of the boards using a square. Move board A forward or back until the edge of the board is flush with the jig. See Figure 29.

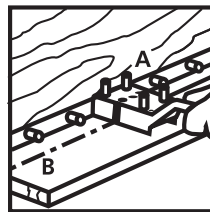

Figure 29

10. Clamp both boards on both sides of the workbench.

11. Using the Quick Dowel Jig as a guide, set the depth stop on the drill bit so you do not drill through board B. Drill a hole for each dowel pin. See Figure 30.

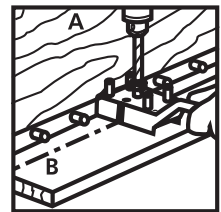

Figure 30

12. Apply wood glue to the dowel pins and assemble the joint.

Making edge-to-edge joints

1. Align two boards in their finished position and mark them "A" and "B". See Figure 31.

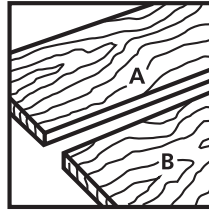

Figure 31

2. Clamp board A to a workbench or clamping table. See Figure 32.

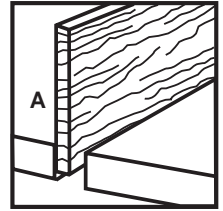

Figure 32

3. Using the Quick Dowel Jig as a guide, place a depth stop on the drill bit at the proper depth for your first hole.

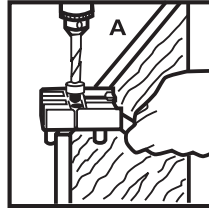

Figure 33

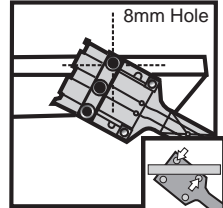

Figure 34

4. Place your Quick Dowel Jig, with the 4 centring pegs pointed down, flat against the edge of board A. Choose the size hole you want to drill and twist the jig to centre it on the end of the board and contact the opposite side with the centring pegs. Depending on the desired hole size, different pairs of pegs are used to centre the jig on the board. See Figures 33-36.

5. Drill through the Quick Dowel Jig and into the edge of the board. Repeat the twist and drill sequence in step 4 as you move down the edge of the board until all holes have been drilled.

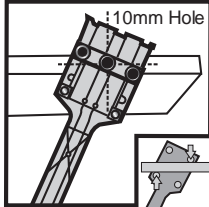

Figure 35

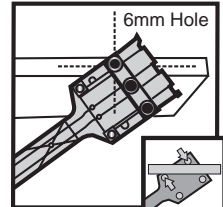

Figure 36

6. After all holes have been drilled, place dowel pins in each hole WITHOUT GLUE. These will be used to position the guide for drilling holes in board B.

7. Attach the angle piece to the dowel jig using the screws and square nuts. Insert the screws through the two holes on the top of the jig and attach the square nuts to the bottom. Do not tighten. Slide the angle piece into the slot between the bottom of the jig and the square nut. Keep the angle piece slightly loose. See Figure 37.

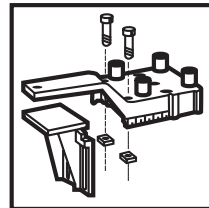

Figure 37

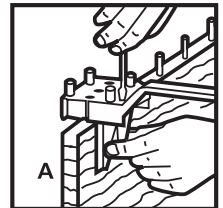

Figure 38

8. With the 4 centring pegs pointed down, slide the Quick Dowel Jig over one of the dowel pins in the edge of board A. Slide the angle piece forward until it rests against the board, then tighten the screws to secure the angle piece to the jig. See Figure 38.

9. Position board B next to board A so that board B is closer to you. The finished sides of the boards should mirror each other; the finished sides of both boards should either be 1) facing each other or 2) facing outward. Use a square to ensure that both boards are properly aligned. Clamp boards together. See Figure 39.

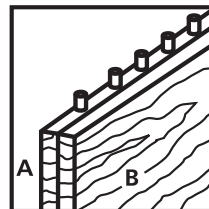

Figure 39

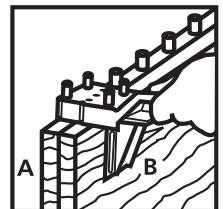

Figure 40

10. Slide the proper slot in the front of the Quick Dowel Jig over a dowel pin in board A. See Figure 40.

11. Drill a hole for each dowel pin. See Figure 40.

12. Apply wood glue to the dowel pins and assemble the joint.