

Digital Vernier Caliper

Please read these instructions carefully and retain them for future use

Technical Specifications

| | |
|---|--|
| Measuring range: | 0-150mm/0-6in |
| Resolution: | 0.01mm/0.0005in |
| Accuracy: | ±0.03mm/0.001in (0 - 200mm) |
| Repeatability: | 0.01mm/0.0005in. |
| Max measuring speed: | 1.5m/sec, 60in/sec. |
| Measuring system: | Linear capacitive measuring system |
| Display: | LCD display. Character Height: 6.35mm |
| Power: | 1 Alkaline battery 1.55V, type LR44 |
| Working temperature: | 5 to 40 degree C, 41 to 104 degree F. |
| Influence of humidity: | Not important under 80% of relative humidity |
| Data output: | Serial output for interface with computer or printer |
| Data processing interface (option): Functions: | Data storage, processing & printing, with software of quality control. |
| Auto power off | 5 minutes |

Your digital caliper was constructed with quality materials and workmanship and will give you many years of trouble free use when cared for as described in the 'Maintenance' section.



EN ISO 14978:2006
03.04.0487ECC



Product Service

In accordance with the
European Directive
ROHS 2002/95/CE
D4 06 07 60503 001

Caliper Features

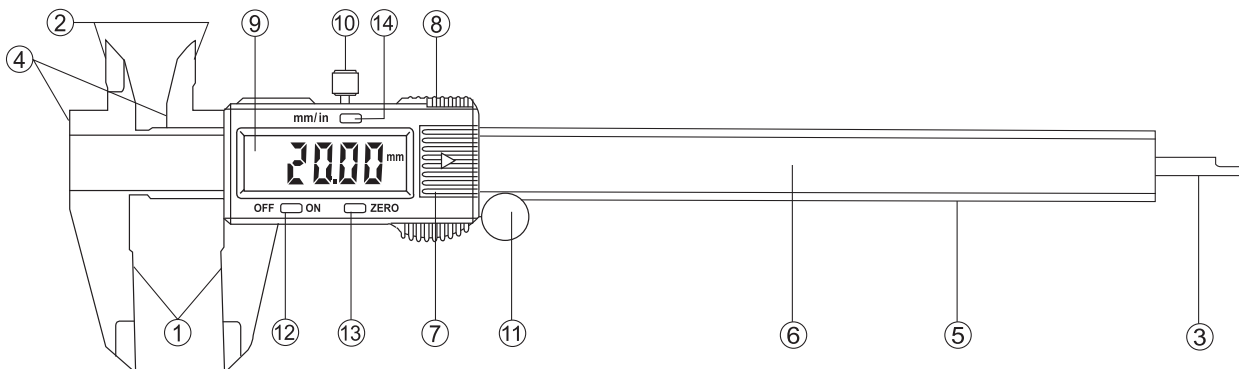

- | | | |
|----------------------------|----------------------------|-------------------------------|
| 1. Outside measuring faces | 6. Main scale | 11. Thumb roller |
| 2. Inside measuring faces | 7. Battery compartment lid | 12. Power ON/OFF switch |
| 3. Depth measuring blade | 8. Data output connector | 13. ZERO switch |
| 4. Step measuring faces | 9. Display(LCD) | 14. Inch/mm conversion switch |
| 5. Beam | 10. Slider clamp screw | |

Applications

Preparations for use:

- Loosen the locking screw (No.10) to allow the sliding head to move.
- Wipe clean all the measuring faces and caliper beam with a lint-free cotton cloth. Never use petrol, acetone and other organic solutions.
- Check to see if all the buttons, switches, and LCD display respond well.

Basic measuring methods:

- Loosen the locking screw.
- Switch the unit on by pressing the "ON" button. Select the unit of measurement required by pressing the Inch/Metric button. (Each time the button is pressed, the display will alternate between inch and metric read out).
- Apply normal measuring pressure on the slider to close the external measuring jaws. Then press the "Zero" button to reset the display to zero.

A Measurements of external dimensions

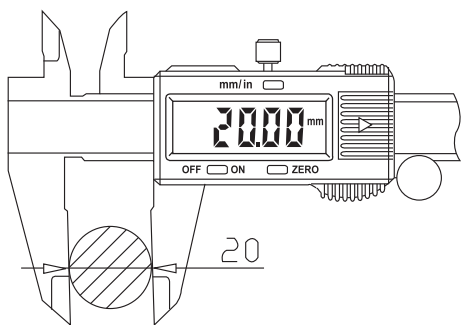

B Measurements of internal dimensions

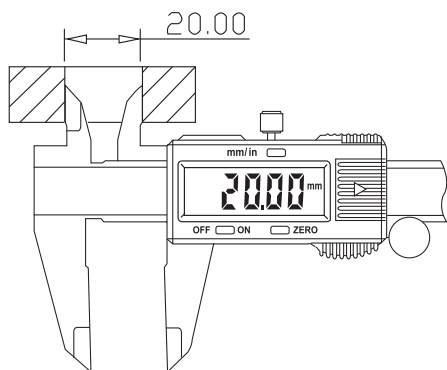

C Measurements of steps

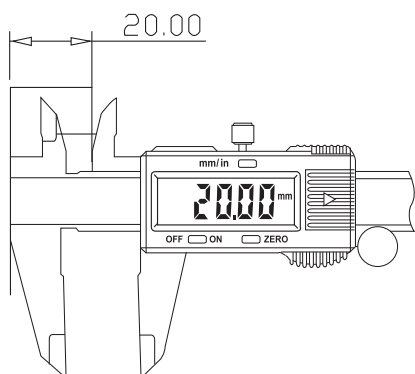

D Measurements of depth

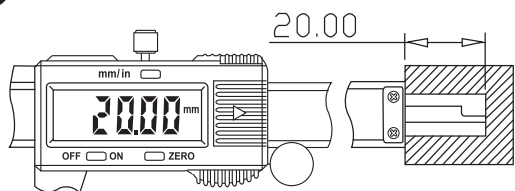

E Differential method measurement (Application of zero setting)

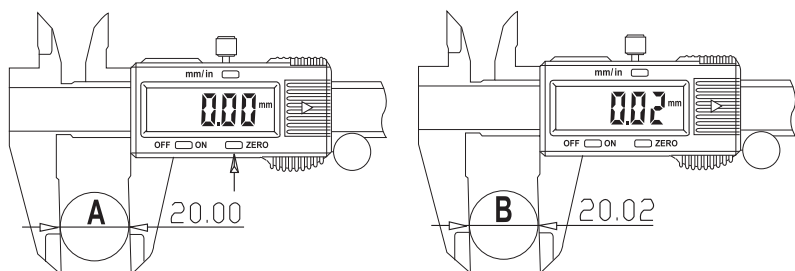

Maintenance Instructions

1. Keep the caliper clean and dry (Liquid may damage the slider head).
2. Faces should be gently cleaned with a lint-free cotton cloth. Never use petrol, acetone and other organic solutions.
3. In order to save battery power, turn the calipers off if they are to remain unused for an extended period.
4. Never apply any electrical current to any part of the caliper or use active electronic test equipment as this may damage the calipers beyond repair.

Battery Replacement

Flashing of the digital display indicates that the battery is flat and will require replacing. Remove the battery cover in the direction shown by the arrow and replace the battery (LR44 or SR44) with the positive side facing out.

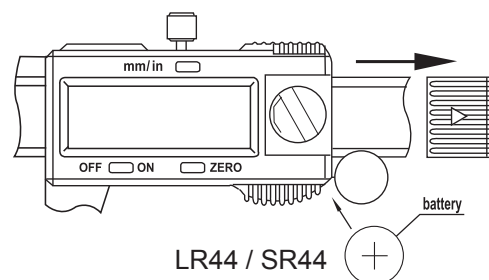

Trouble Shooting

| Failure | Cause | Measure |
|--|---|---|
| Five digits flash simultaneously, about once per second. | Battery voltage lower than 1.45V | Replace the battery |
| Display does not change when the slider is moved | Problem with the electronic circuit | Remove the battery and replace it after 30 Seconds. |
| Less accurate than specified but within +0.1mm | Dirt in the sensor | Remove slider cover and its assembly. Clean with compressed air (5kg/cm) |
| No display on LCD | 1. Battery in poor contact 2. Battery voltage under 1.4V | 1. Remove battery cover and adjust the battery contact to make a good connection. 2. Replace battery |



FAITHFULL TOOLS
Phoenix House,
3 White Lodge Business Estate,
Hall Road, Norwich, Norfolk, NR4 6DG
E-mail: enquiries@faithfulltools.com

www.fairthfulltools.com