



WRENCHES

ADJUSTABLE BASIN WRENCHES

These basin wrenches have adjustable spring action jaws that maintain an automatic grip on pipe fittings. The forged steel jaws turn 180° for greater flexibility.

They are an essential tool for use on compression fittings, copper or polythene, on basins and baths.

Operates at most angles in difficult work areas

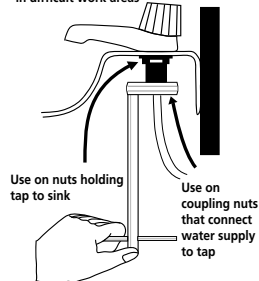

The 'BWADJ' model is equipped with adjustable jaws for working on pipe fittings from 6mm to 25mm.

The 'BWADJEXT' has a telescopic handle that extends to 400mm and will fit pipe fittings from 6mm to 25mm.

The 'BWADJL' bath wrench has a larger jaw for pipe fittings from 25mm to 50mm.

	STOCK NO	DESCRIPTION	CAPACITY	EX VAT	INC VAT
A	FAI BWADJ	ADJ. BASIN WRENCH	6 - 25mm	£10.70	£12.84
B	FAI BWADJEXT	ADJ. BASIN WRENCH	6 - 25mm	£14.50	£17.40
C	FAI BWADJL	ADJ. BASIN WRENCH	25 - 50mm	£12.77	£15.32

BASIN WRENCH

The 'BW1' is a double-ended wrench suitable for working on 15mm and 22mm fittings. Ideal for use in awkward places such as backnuts fitted to taps behind sinks or baths.

	STOCK NO	DESCRIPTION	EX VAT	INC VAT
D	FAI BW1	BASIN WRENCH TO FIT 15mm & 22mm	£5.20	£6.24

IMMERSION HEATER SPANNERS

A range of three models - box, cranked and flat. All are made from steel and have a jaw size of 86mm (3³/₈ inch). The cranked and box types are for use on tanks manufactured complete with integral foam lagging.

	STOCK NO	DESCRIPTION	EX VAT	INC VAT
E	FAI IHS	FLAT IMMERSION SPANNER	£4.16	£4.99
F	FAI IHS C	CRANKED IMMERSION SPANNER	£4.40	£5.28
G	FAI IHS B	BOX IMMERSION SPANNER	£7.20	£8.64